



# Physical Distance Planning for Classrooms - Fall 2020

# Small Classroom–Layout Comparison

## 6112 Social Science Bldg.

### Normal Layout

### Physical Distancing Layout



Room 6112 Social Science



Room 6112 Social Science



Please return seating to this configuration when your class is finished.

Please return seating to this configuration when your class is finished.

- Station Count: 34 movable tablet arm chairs
- Instructor Station: Chair, table, portable lectern

- Station Count: 11 movable tablet arm chairs
- Instructor Station: Chair, table, portable lectern

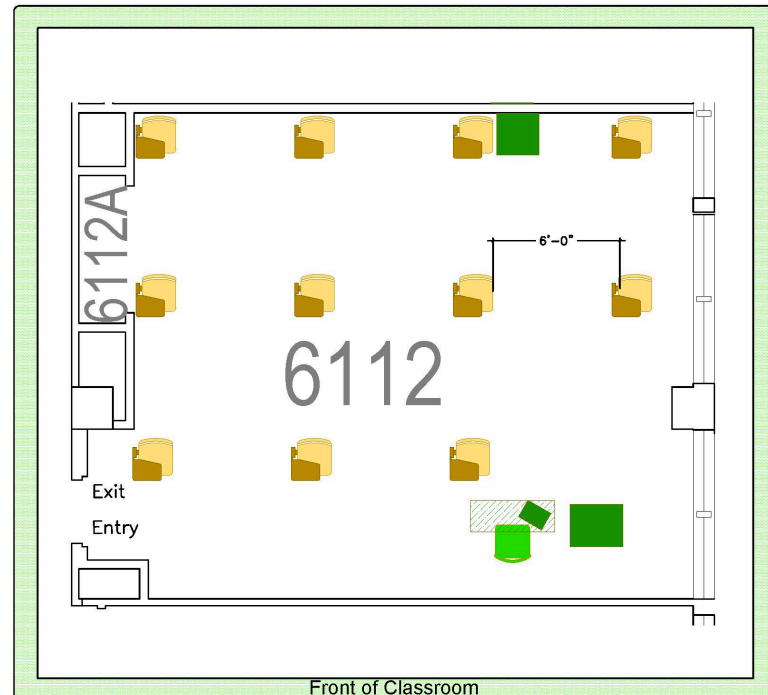
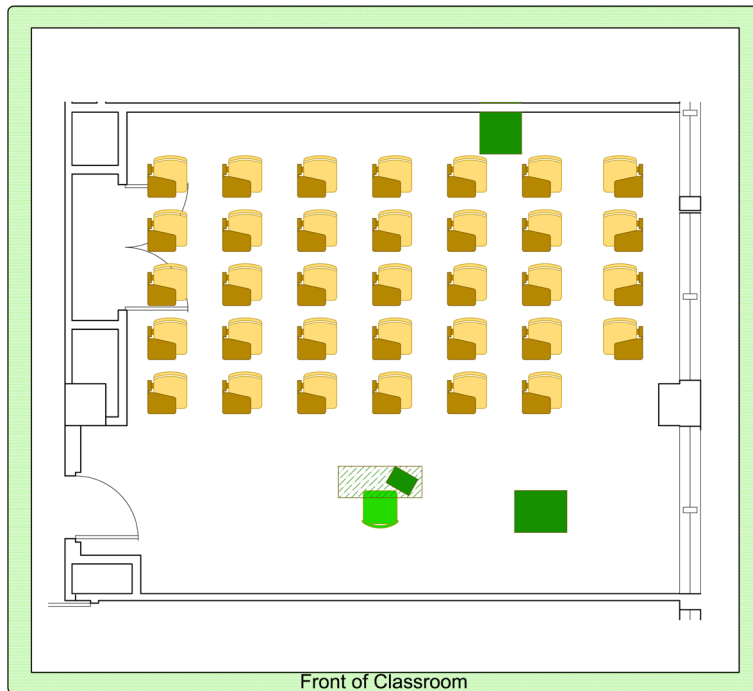

Place all trash and recycling in the proper container.

Please contact the Space Management Office at 262-4414 if you have questions or comments about this classroom.  
Sep 2017

Place all trash and recycling in the proper container.

Please contact the Space Management Office at 262-4414 if you have questions or comments about this classroom.  
May 2020

# Small Classroom–Layout Comparison

## Nancy Nicholas Hall Room 1125

### Normal Layout

### Physical Distancing Layout



Room 1125 Nicholas Hall



Room 1125 Nicholas Hall



Please return seating to this configuration when your class is finished.

Please return seating to this configuration when your class is finished.

- Station Count: 18 movable tables and 36 movable chairs
- Instructor Station: Chair, table, portable lectern

- Station Count: 12 Movable Chairs at 12 Tables
- Instructor Station: Chair, table, portable lectern

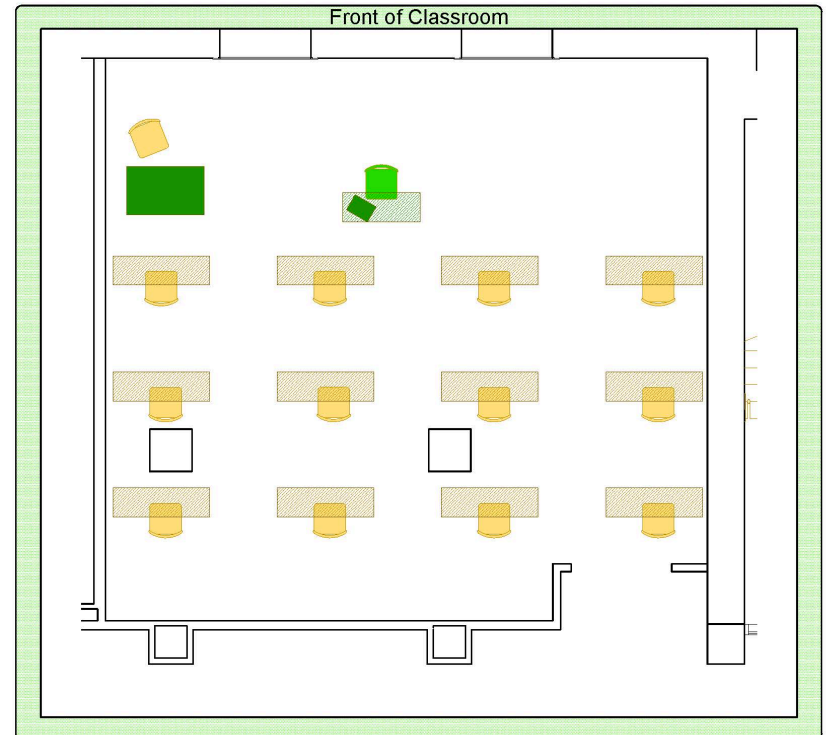
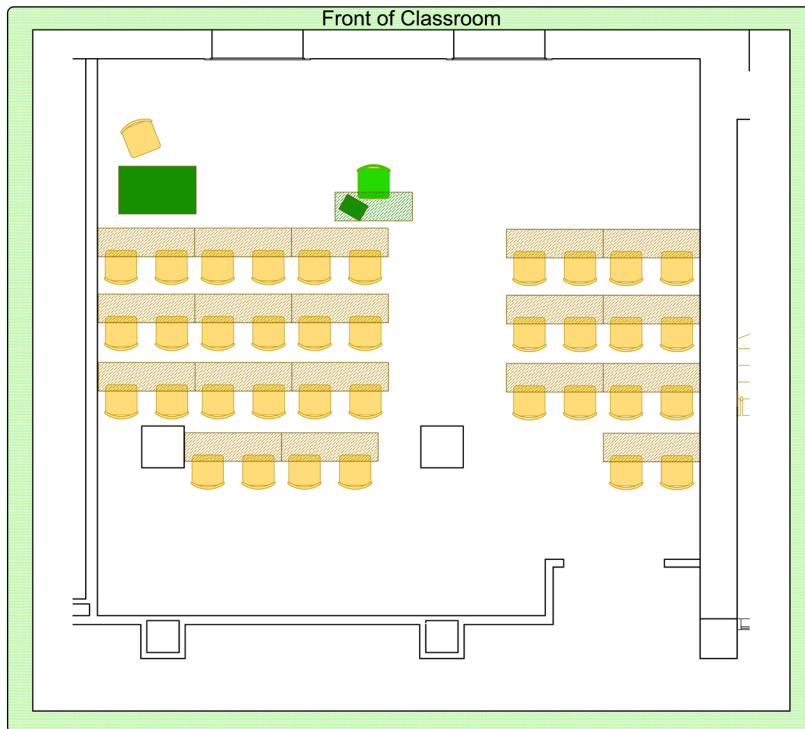

Place all trash and recycling in the proper container.

Place all trash and recycling in the proper container.

Please contact the Space Management Office at 262-4414 if you have questions or comments about this classroom.

Please contact the Space Management Office at 262-4414 if you have questions or comments about this classroom.

Sep 2017

Sep 2017

# Small Classroom – Layout Comparison

## Educational Sciences Bldg. Room 218

### Normal Layout



Room 218 Educational Sciences



Please return seating to this configuration when your class is finished.

- Station Count: 30 Tablet Arm Chairs
- Instructor Station: Chair, table, portable lectern

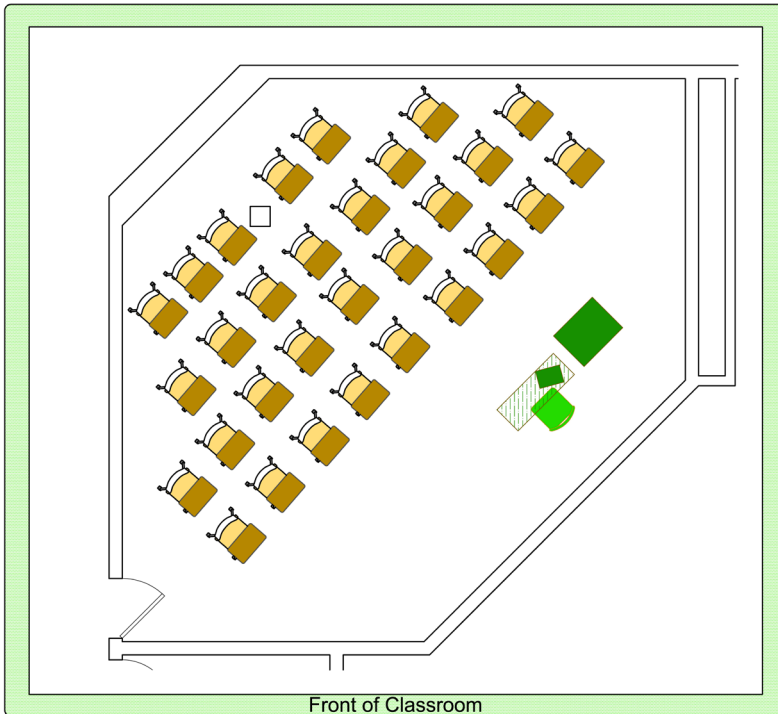

Place all trash and recycling in the proper container.

Please contact the Space Management Office at 262-4414 if you have questions or comments about this classroom.

Dec 2016

### Physical Distancing Layout



Room 218 Educational Sciences



Please return seating to this configuration when your class is finished.

- Station Count: 12 Tablet Arm Chairs
- Instructor Station: Chair, table, portable lectern

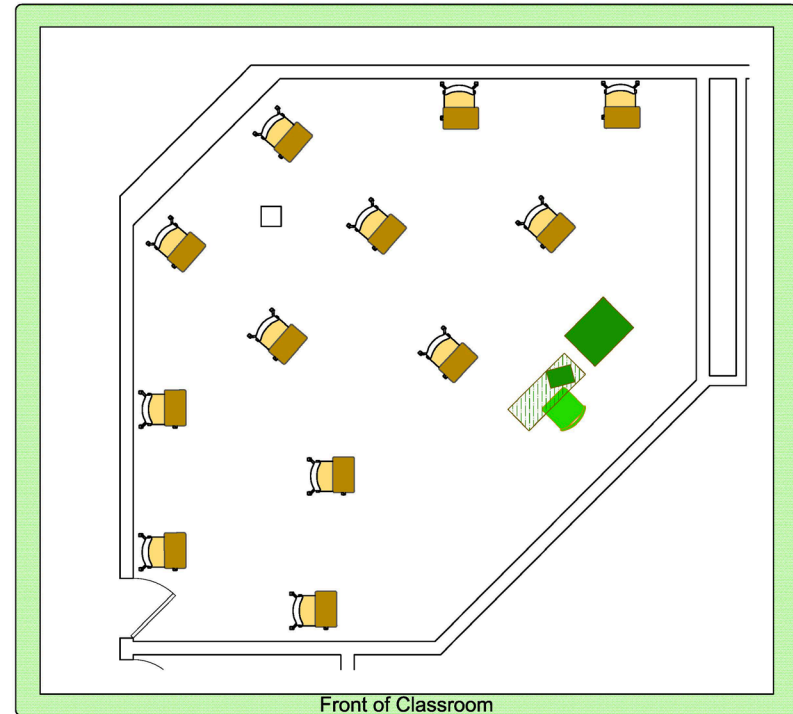

Place all trash and recycling in the proper container.

Please contact the Space Management Office at 262-4414 if you have questions or comments about this classroom.

Dec 2016



# Collaborative Classroom–Layout Comparison Educational Sciences Bldg. Room 212

## Normal Layout



Room 212 Educational Sciences



Please return seating to this configuration when your class is finished.

- Station Count: 64 movable chairs at 8 tables
- Instructor Station: 2 Chairs, table, portable lectern, stool, AV podium

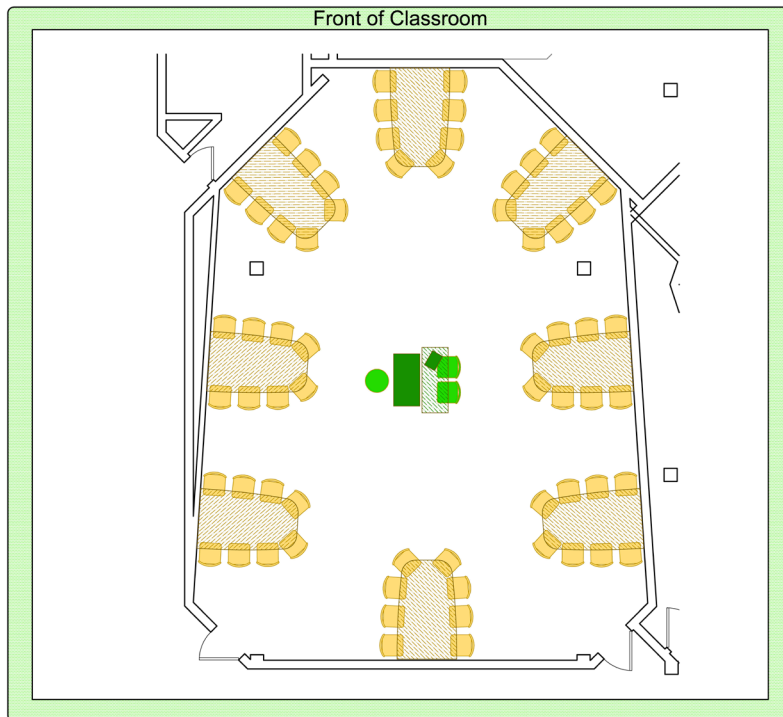

Place all trash and recycling in the proper container.

Please contact the Space Management Office at 262-4414 if you have questions or comments about this classroom.  
Dec 2016

## Physical Distancing Layout



Room 212 Educational Sciences



Please return seating to this configuration when your class is finished.

- Station Count: 19 movable chairs at 8 tables
- Instructor Station: 2 Chairs, table, portable lectern, stool, AV podium

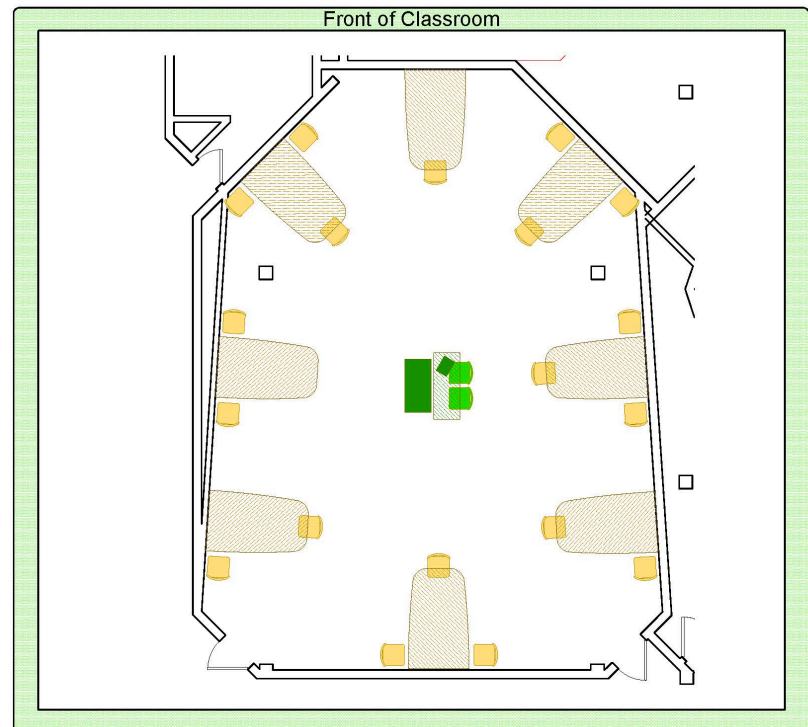

Place all trash and recycling in the proper container.

Please contact the Space Management Office at 262-4414 if you have questions or comments about this classroom.  
Dec 2016

# Collaborative Classroom–Layout Comparison Sterling Hall Room 3425

## Normal Layout



Room 3425 Sterling Hall



Please return seating to this configuration when your class is finished.

- Station Count: 36 movable chairs at 6 collaborative tables
- Instructor Station: Chair, table, portable lectern

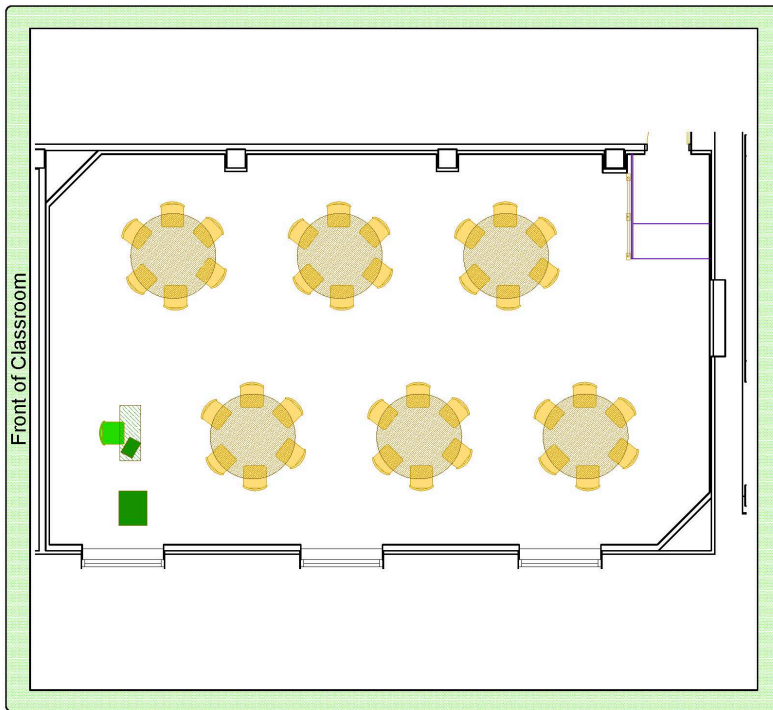

Place all trash and recycling in the proper container.

Please contact the Space Management Office at 262-4414 if you have questions or comments about this classroom.  
Jan 2019

## Physical Distancing Layout



Room 3425 Sterling Hall



Please return seating to this configuration when your class is finished.

- Station Count: 18 movable chairs at 6 collaborative tables
- Instructor Station: Chair, table, portable lectern

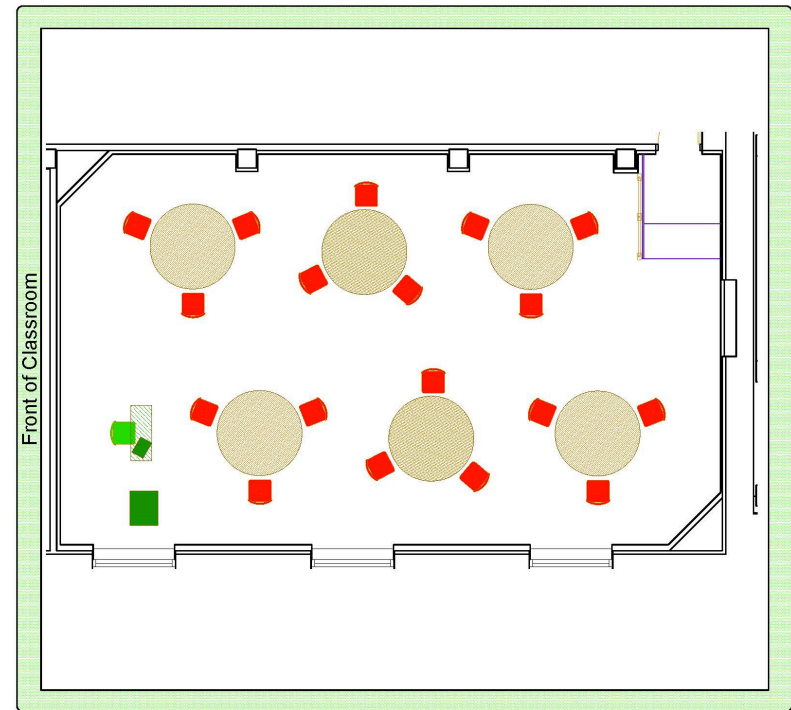

Place all trash and recycling in the proper container.

Please contact the Space Management Office at 262-4414 if you have questions or comments about this classroom.  
Jan 2019

# Collaborative Classroom–Layout Comparison Ingraham Hall Room 122

## Normal Layout



Room 122 Ingraham Hall



Please return seating to this configuration when your class is finished.

- Station Count: 48 movable chairs at 6 tables
- Instructor Station: Chair, table, stool, AV podium

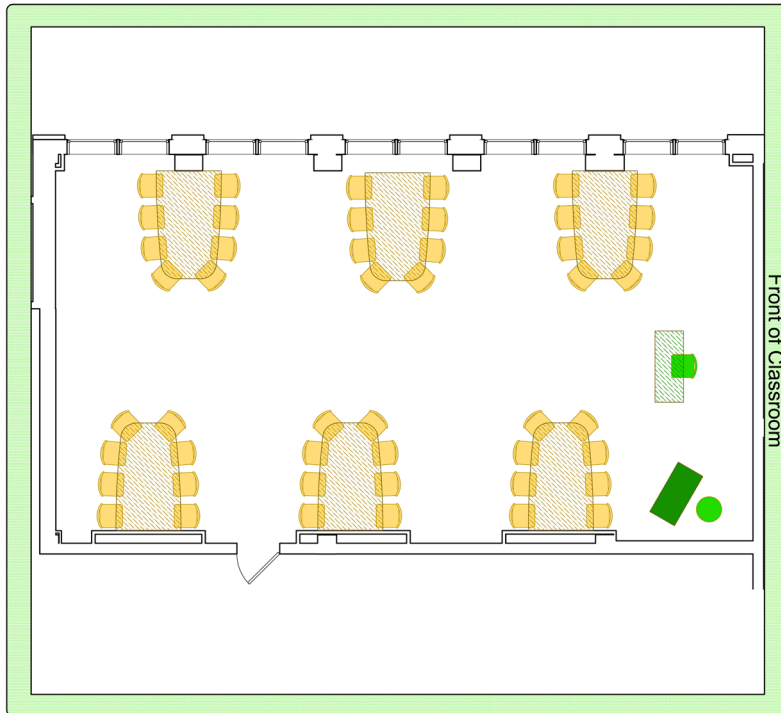

Place all trash and recycling in the proper container.

Please contact the Space Management Office at 262-4414 if you have questions or comments about this classroom.  
Nov 2016

## Physical Distancing Layout



Room 122 Ingraham Hall



Please return seating to this configuration when your class is finished.

- Station Count: 18 movable chairs at 6 tables
- Instructor Station: Chair, table, stool, AV podium

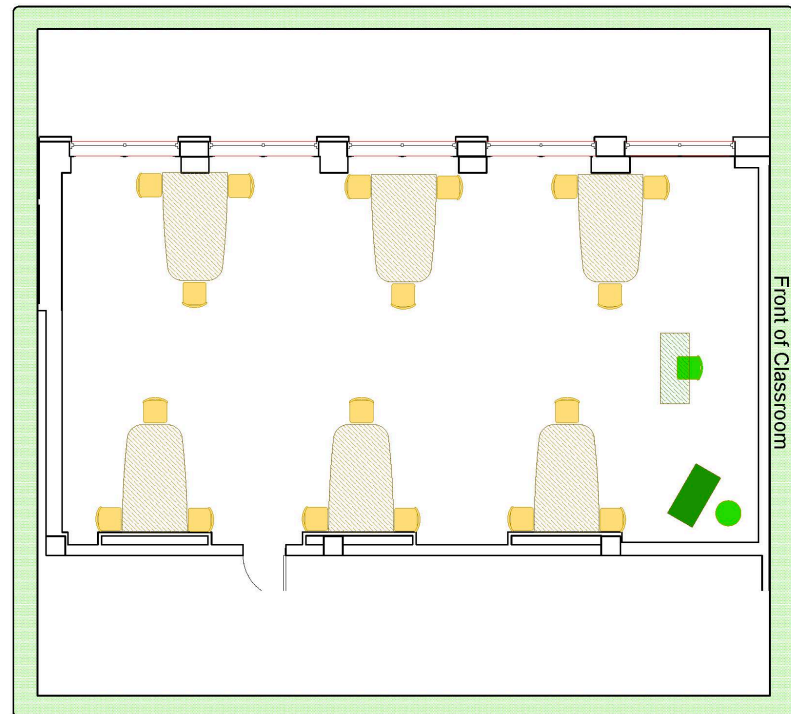

Place all trash and recycling in the proper container.

Please contact the Space Management Office at 262-4414 if you have questions or comments about this classroom.  
Nov 2016

# Small Lecture Hall–Layout Comparison Chamberlin Hall Room 2241

## Normal Layout



Room 2241 Chamberlin Hall



Please return seating to this configuration when your class is finished.

- Station Count: 173 movable seats
- Instructor Station: Fixed counter

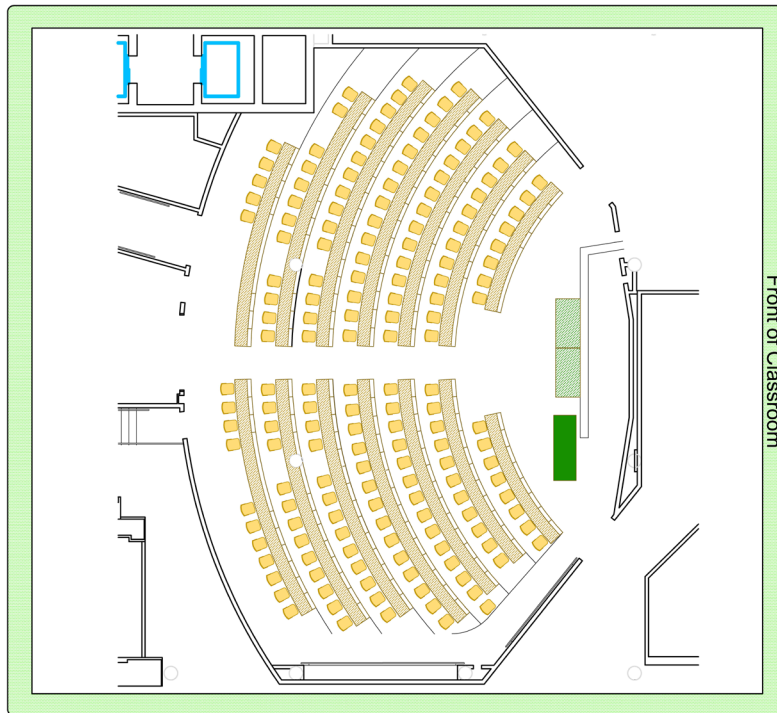

Place all trash and recycling in the proper container.

Please contact the Space Management Office at 262-4414 if you have questions or comments about this classroom.  
Sep 2017

## Physical Distancing Layout



Room 2241 Chamberlin Hall



Please return seating to this configuration when your class is finished.

- Station Count: 55 movable seats
- Instructor Station: Fixed counter

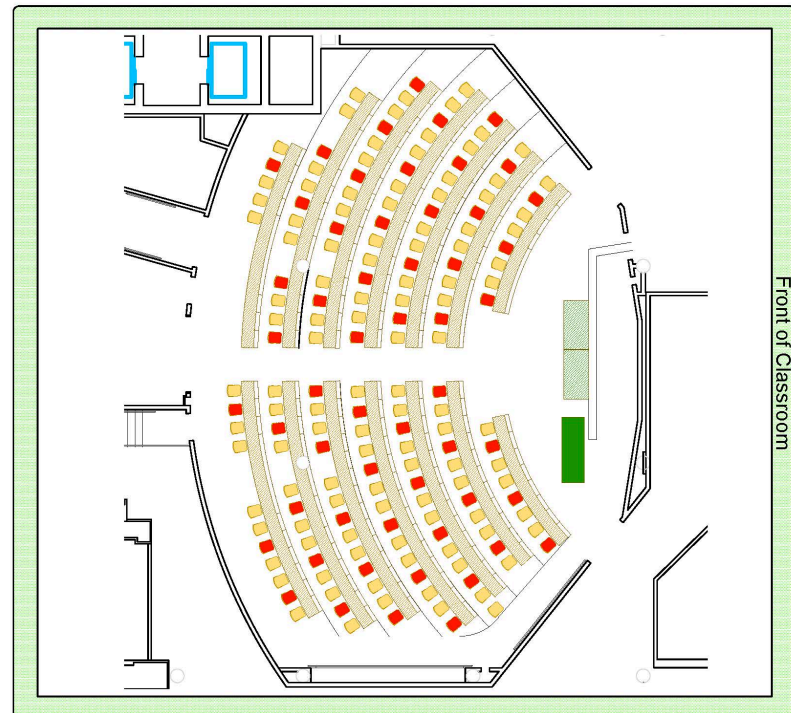

Place all trash and recycling in the proper container.

Please contact the Space Management Office at 262-4414 if you have questions or comments about this classroom.  
Sep 2017



# Small Lecture Hall–Layout Comparison Animal Science Bldg. Room 212

## Normal Layout



Room 212 Animal Science



Please return seating to this configuration when your class is finished.

- Station Count: 152 fixed seats
- Instructor Station: Chair, table, portable lectern

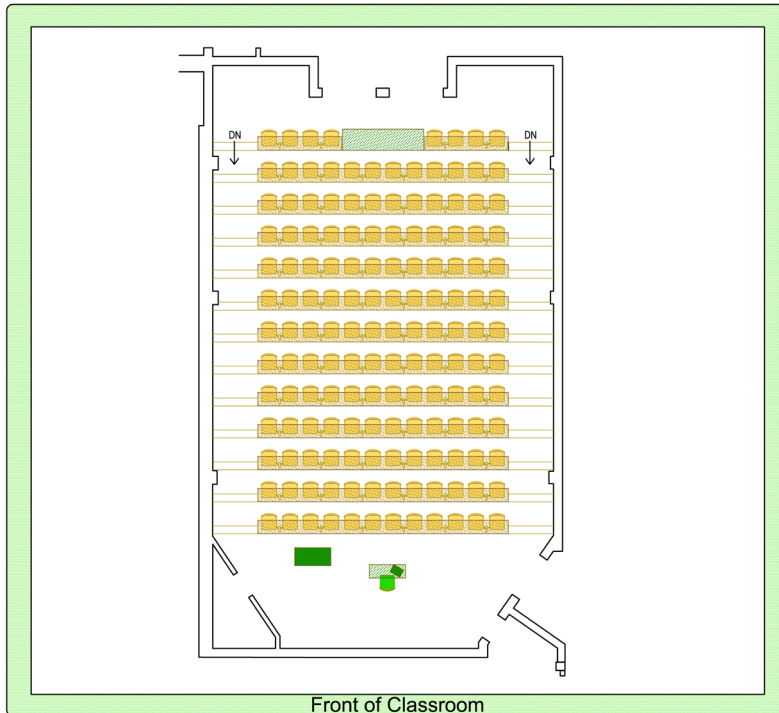

Place all trash and recycling in the proper container.

Please contact the Space Management Office at 262-4414 if you have questions or comments about this classroom.

## Physical Distancing Layout



Room 212 Animal Science



Please return seating to this configuration when your class is finished.

- Station Count: 33 Fixed Seats and 1 Movable Chair
- Instructor Station: Chair, table, portable lectern



Place all trash and recycling in the proper container.

Please contact the Space Management Office at 262-4414 if you have questions or comments about this classroom.

# Small Lecture Hall–Layout Comparison Grainger Hall Room 2120

## Normal Layout



Room 2120 Grainger Hall



Please return seating to this configuration when your class is finished.

- Station Count: 135 movable chairs, 24 fixed tables, 8 tablet chairs
- Instructor Station: Chair, table, portable lectern

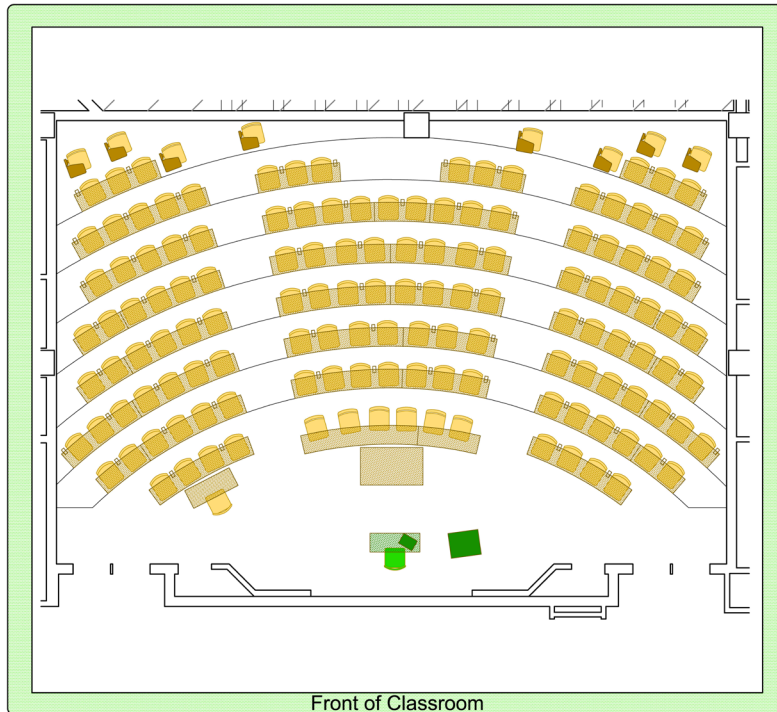

Place all trash and recycling in the proper container.

Please contact the Space Management Office at 262-4414 if you have questions or comments about this classroom.

Oct 2017

## Physical Distancing Layout



Room 2120 Grainger Hall



Please return seating to this configuration when your class is finished.

- Station Count: 27 Movable Chairs at Fixed Tables, 4 Tablet Arm Chairs
- Instructor Station: Chair, table, portable lectern

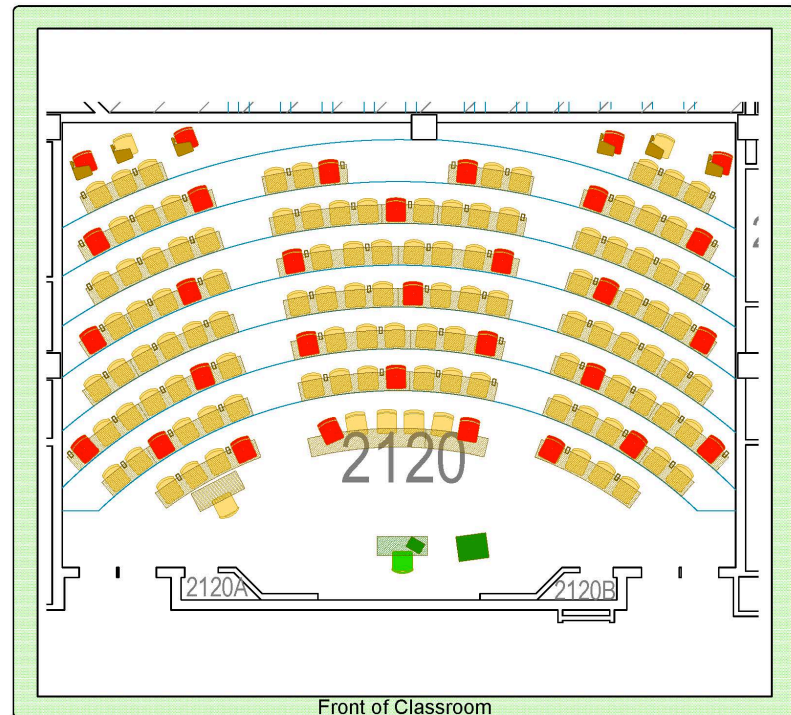

Place all trash and recycling in the proper container.

Please contact the Space Management Office at 262-4414 if you have questions or comments about this classroom.

Oct 2017



# Large Lecture Hall–Layout Comparison Ingraham Hall Room B10

## Normal Layout



Room B10 Ingraham Hall



Please return seating to this configuration when your class is finished.

- Station Count: 484 Fixed seats
- Instructor Station: Chair, table, portable lectern

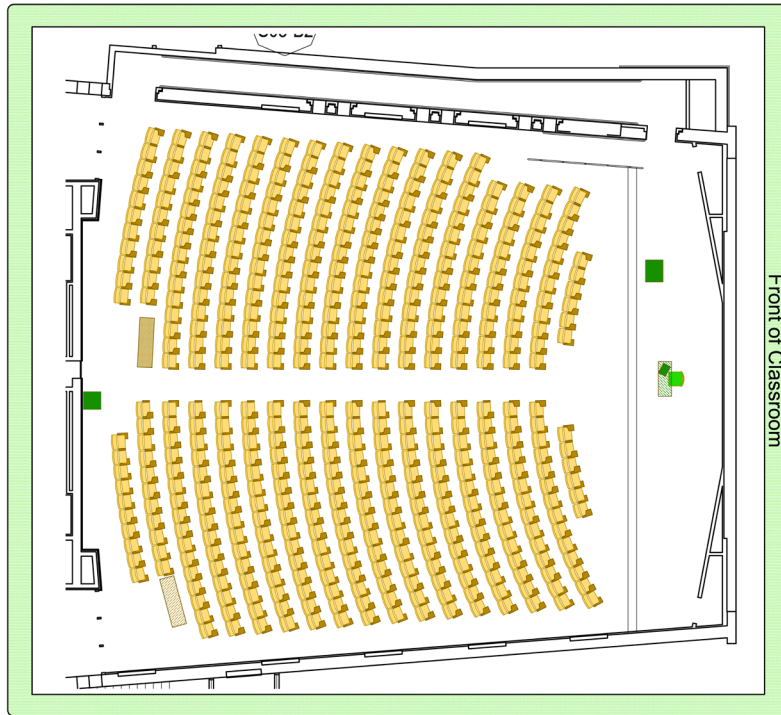

Place all trash and recycling in the proper container.

Please contact the Space Management Office at 262-4414 if you have questions or comments about this classroom.  
Sep 2017

## Physical Distancing Layout



Room B10 Ingraham Hall



Please return seating to this configuration when your class is finished.

- Station Count: 68 Fixed Seats
- Instructor Station: Chair, table, portable lectern

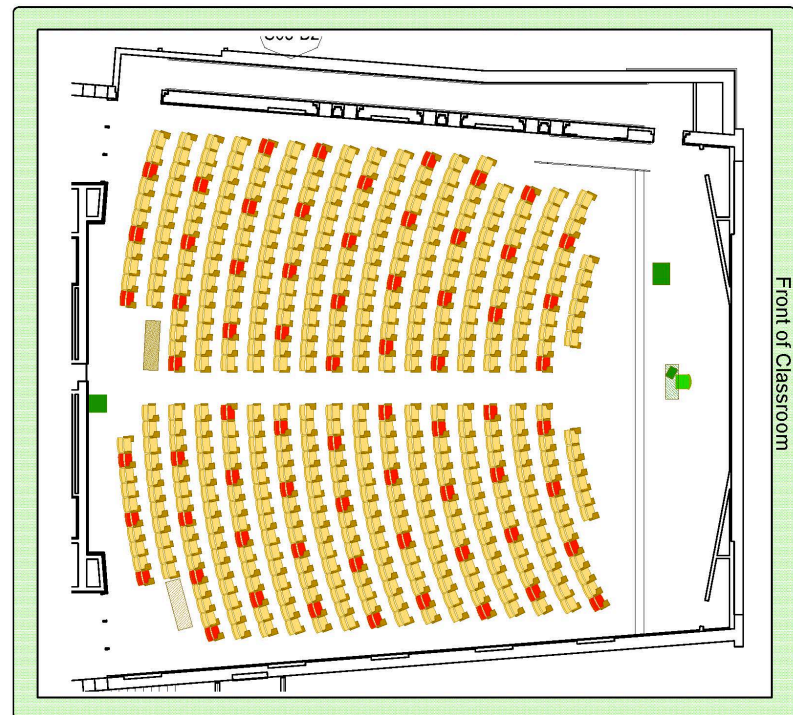

Place all trash and recycling in the proper container.

Please contact the Space Management Office at 262-4414 if you have questions or comments about this classroom.  
Sep 2017

# Large Lecture Hall–Layout Comparison

## Social Science Bldg. Room 6210

### Normal Layout

### Physical Distancing Layout



Room 6210 Social Science



Room 6210 Social Science



Please return seating to this configuration when your class is finished.

Please return seating to this configuration when your class is finished.

- Station Count: 442 fixed seats & 6 movable seats
- Instructor Station: Chair, table, portable lectern

- Station Count: 67 fixed seats and 3 tablet arm chairs
- Instructor Station: Chair, table, portable lectern

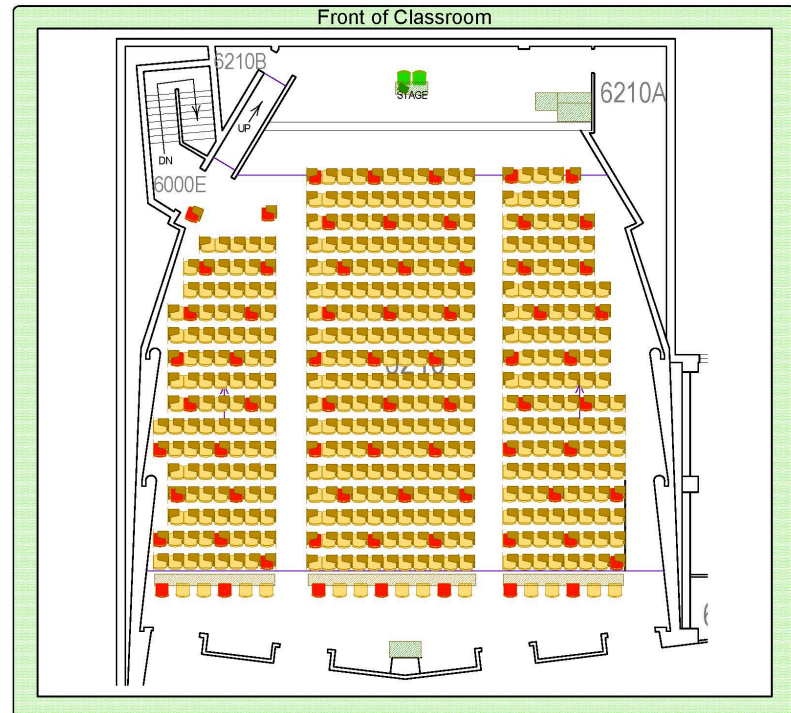
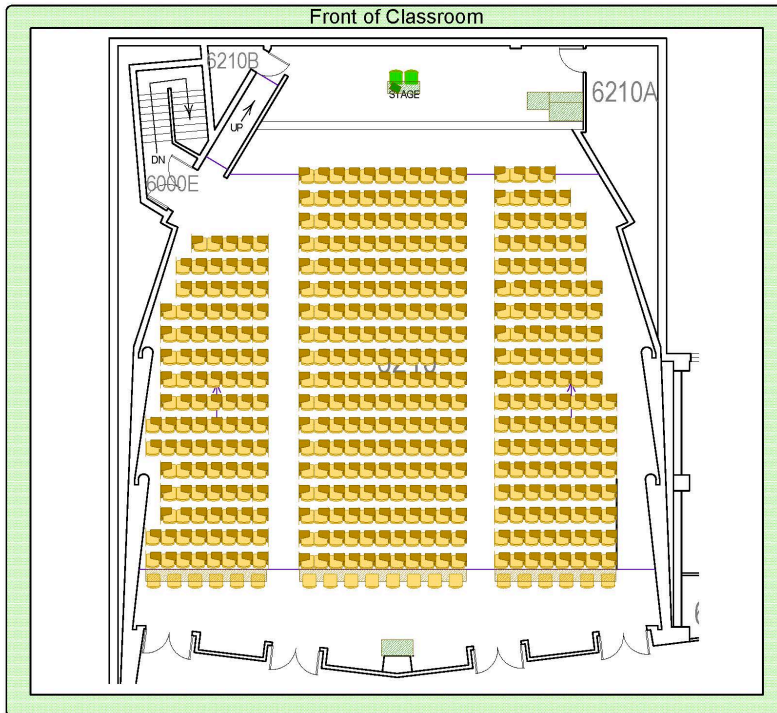

Place all trash and recycling in the proper container.

Place all trash and recycling in the proper container.

Please contact the Space Management Office at 262-4414 if you have questions or comments about this classroom.

Please contact the Space Management Office at 262-4414 if you have questions or comments about this classroom.

Sep 2017

Sep 2017

# Large Lecture Hall–Layout Comparison Grainger Hall Room 1100

## Normal Layout

## Physical Distancing Layout



Room 1100 Grainger Hall



Room 1100 Grainger Hall



Please return seating to this configuration when your class is finished.

Please return seating to this configuration when your class is finished.

- Station Count: 278 fixed seats
- Instructor Station: Chair, table, portable lectern

- Station Count: 46 fixed seats
- Instructor Station: Chair, table, portable lectern

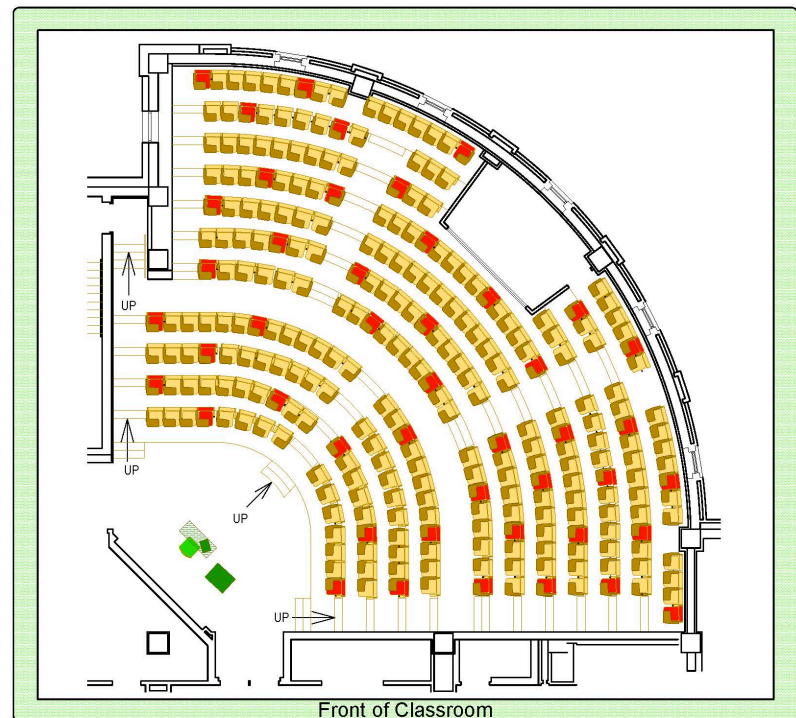
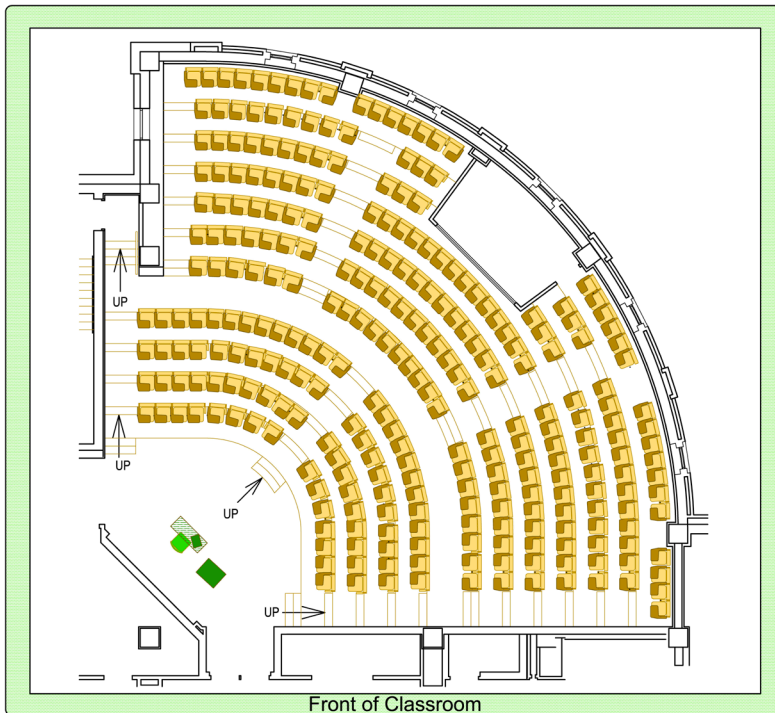

Place all trash and recycling in the proper container.

Please contact the Space Management Office at 262-4414 if you have questions or comments about this classroom.  
Oct 2017

Place all trash and recycling in the proper container.

Please contact the Space Management Office at 262-4414 if you have questions or comments about this classroom.  
Oct 2017